

www.pristino.com

PRISTINE INDUSTRIES

Registered Office:

The Lords, 8 Strand Road
2nd Floor, Kolkata-700001,
West Bengal, India.

Factory Address:

Mahabir Complex,
Delhi Road, Dhobapukur,
Bighati, Hooghly-712124.



Pristino™

FITS YOUR NEEDS

An ISI (IS:733) & ISO 9001 Certified Organisation



**MANUFACTURER OF PREMIUM
QUALITY ALUMINIUM PROFILES**

ARCHITECTURAL

INDUSTRIAL

ELECTRICAL

SOLAR PANEL

FURNITURE & FITTINGS

TRANSPORT & DEFENCE



 +91-760 30 83 768

pristino@alSmith.org



DESIGNED BY

Edition 2- August 2022

PRISTINE INDUSTRIES
www.pristino.com



TABLE OF CONTENTS

Content	Page No.	Content	Page No.
About Pristine Industries	3	20 mm 2 Track Top	39
Our Team	8	20 mm 2 Track Bottom	39
Technical Information	10-22	20 mm 3 Track Top	40
Architectural Sections		20 mm 3 Track Bottom	40
Rectangular Tube	23	20 mm Sec A (Handle)	41
Square Tube	23	20 mm Interlock	41
Single Partition	24	20 mm H-Sec (Bearing Top Bottom)	42
Double Partition	24	25 mm 2 Track Top	43
Door Middle Single	25	25 mm 2 Track Bottom	43
Door Middle Double	25	25 mm 3 Track Top	44
Door Vertical	26	25 mm 3 Track Bottom	44
Door Top	26	25 mm Handle	45
Door Bottom	27	25 mm Interlock	45
1 1/2 x 1L Tube	27	25 mm Bearing Top Bottom	46
Corner Partition (Patam - Gundi)	28	40 mm Mullion	47
Glass Section 12 mm Solid	28	40 mm Z Frame	47
34 Series 'Z' Mullion	29	40 mm Outer Frame	48
34 Series 'Z' Section	29	40 mm G Clip	48
34 Series Outer	29	Louver Section	49
34 Series Clip	30	G Section	52
Clit Angle	30	63 x 38 Wooden Choukhat	52
Curtain Wall	31	Plain Round Tube	53
Structural GLazing	31	Flat Bar	53
18 mm 2 Track Top	32	Glazing Plate	54
18 mm 2 Track Bottom	32	Equal Angle	54
18 mm 3 Track top	33	Unequal Angle	55
18 mm 3 Track Bottom	33	Single Channel	55
18 mm 4 Track Top	34	Double Glass Channel	56
18 mm 4 Track Bottom	34	Plain Tee	56
18 mm 3/4" Handle	35	Buld Tee	57
18 mm 3/4" Middle	35	Glazing Clip	57
18 mm 3/4" Top Bottom	36	Fluted Round Tube	58
18 mm 3/4" Interlock	36	Step Ladder	58
18 mm Sintex A	37	C Ladder	58
18 mm 18 x 80 Matting	37	Solar Corner	59
25 mm 1" Handle	37	Solar Frames	60
25 mm 1" Top Bottom	38	Euro Series	61

OUR SISTER CONCERN

STERILE EXTRUSIONS PRIVATE LIMITED

Office Address:

THE LORDS,
2C, 2D, 2ND FLOOR,
8, Strand Road,
KOLKATA - 700001

Email : sterile@alsmith.org

Factory Address:

Plot no. 2909, 2910
NH2 Bypass, Near Chowringhee,
Lachmanpur, Post - Salanpur,
West Bengal - 713357

Email - sterile.extrusions@gmail.com

Product:

Aluminium extrusions of all varieties of the architectural, commercial and industrial needs and also Aluminium Ladders.

Capacity:

Manufacturing capacity 4200 MT.

Anodizing capacity 1800MT.

Licenses / Certification:

MSME certified & Import & Export certified.

ISO Certification.



OUR SISTER CONCERN

KRISHNA ALEX PRIVATE LIMITED

Office Address:

THE LORDS,
2C, 2D, 2ND FLOOR,
8, Strand Road,
KOLKATA - 700001

Email : krishna@alsmith.org

Factory Address:

Sankrail Industrial Park,
NH - 6, Bombay Road,
P. S . S a n k r a i l,
D h u l a g a r h
Howrah - 711302

Product:

Aluminium extrusions of all varieties of the architectural, commercial and industrial needs.

Capacity:

Manufacturing capacity 7200 MT.
Anodizing capacity 3600 MT.

Licenses / Certification:

MSME certified & Import & Export certified.
Having ISO Certification.



PRISTINE INDUSTRIES

3

Pristino has different shapes and sizes of profiles meeting the various customers' requirement of Architectural & Structural Glazing, Air Handling, Irrigation, Defence and Govt. Organization, Display Systems, Electrical and Electronics, Hospital Equipments, Modular Furniture, Motor Bodies, Pharma Clean Rooms, Pneumatics, Tele Communications, Transport, Mobile Shelter, Solar Profiles, General Engineering and Tailor made special applications of specific requirements etc.



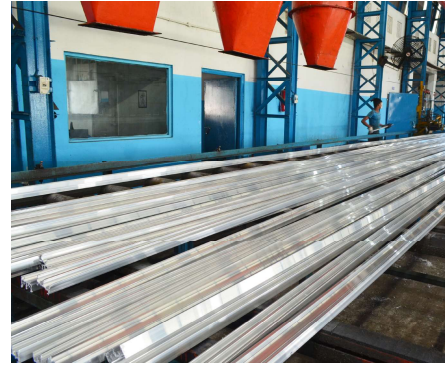

SECTION NO.: PI - 78-6
Weight: 0.870-0.970 kg / 12'

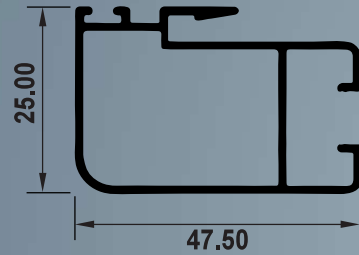
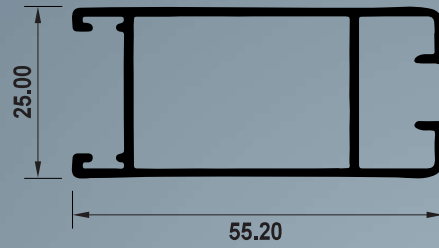

SECTION NO.: PI - 78-7
Weight: 1.800-1.900 kg / 12'

SECTION NO.: PI - 78-9
Weight: 0.900 - 1.000 kg / 12'

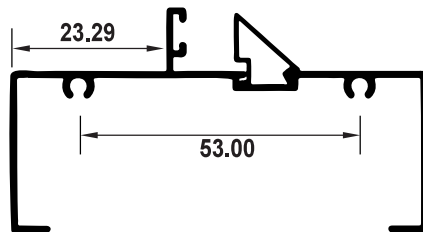
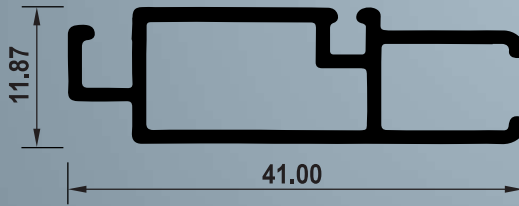

SECTION NO.: PI - 78-11
Weight: 1.750-1.850 kg / 12'





भारतीय मानक ब्यूरो
उपभोक्ता मामले, खाद्य एवं सार्वजनिक वितरण मंत्रालय
भारत सरकार
BUREAU OF INDIAN STANDARDS
Ministry of Consumer Affairs, Food & Public Distribution
Government of India

हमारा संदर्भ : केकेबीओ-II सीएम एल- 5500117504
Our Ref: KKBO-II CML- 5500117504

दिनांक / Date : 17.05.2022

विषय: भारतीय मानक IS 733:1983. : के अनुसार बीआईएस प्रमाणन मुहरांकन लाइसेंस संख्या 5500117504 की स्वीकृति।
Subject: Grant of BIS Certification Marks Licence No 5500117504 as per IS 733:1983.

मेसर्स प्रिस्टीन इंडस्ट्रीज़
महाबीर कोम्प्लेक्स, ब्लॉक- सिंगूर,
विलेज - धोबापूर, पि ओ- बिगहाती,
पि एस- भद्रेश्वर, हुगली,
पश्चिम बंगाल, इंडिया - 712124

M/S PRISTINE INDUSTRIES
MAHABIR COMPLEX, BLOCK - SINGUR,
VILL - DHOBAPUR, P.O-BIGHATI,
P.S-BHADRESWAR, HOOGHLY,
WEST BENGAL, INDIA- 712124

प्रिय महोदय/महोदया,
Dear Madams(s)/Sir,

आपके आवेदन के संदर्भ में, हमें आपको यह सूचित करते हुए प्रसन्नता हो रही है कि निम्नलिखित के संबंध में मानक मुहरांकन के उपयोग हेतु आप को प्रमाणन मुहरांकन लाइसेंस प्रदान किया गया है:

उत्पाद: राट एल्युमिनियम एंड एल्युमिनियम आल्सोय बार्स, रडस एंड सेकसानस (फर जेनराल इंजीन्यरिंग पारपासेस)
IS 733:1983

ग्रेड/वर्ग/प्रकार/प्रकृति

Regular Solid Section(Angle).Dimensions(Upto and including) - Height-50 mm.Width-25mm.Thickness 6.1 mm.Designation - 63400.Condition - O
Regular Solid Section(Rectangular Tube).Dimension(Upto and including) - Height-50mm.Width-100 mm.Thickness-4.1 mm. Designation - 63400.Condition-O
Bars.Dimension(Upto and including)- Width-100 mm.Thickness-25 mm. Designation - 63400.Condition-O
Irregular Solid Section.Designation - 63400.Condition-O

With reference to your application, we are pleased to inform you that the Certification Marks Licence has been granted to you to use the Standard Mark in respect of the followings:

Product: Wrought Aluminium and Aluminium Alloy Bars, Rods and Sections (for General Engineering Purposes)

IS 733:1983

Grade/Class/Type/Variety

Regular Solid Section(Angle).Dimensions(Upto and including) - Height 50 mm.Width-25mm.Thickness-6.1 mm.Designation - 63400.Condition - O
Regular Solid Section(Rectangular Tube).Dimension(Upto and including) - Height-50mm.Width-100 mm.Thickness-4.1 mm. Designation - 63400.Condition-O
Bars.Dimension(Upto and including)- Width-100 mm.Thickness-25 mm. Designation - 63400.Condition-O
Irregular Solid Section.Designation - 63400.Condition-O

पूर्वी क्षेत्रीय कार्यालय

Eastern Regional Office

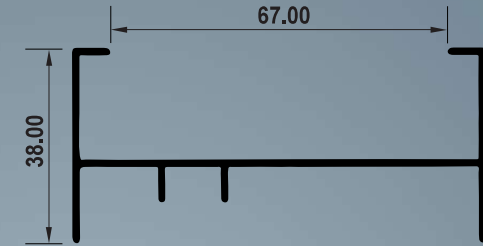

SECTION NO.: PI - 78-3

Weight: 1.700-1.800 kg / 12'

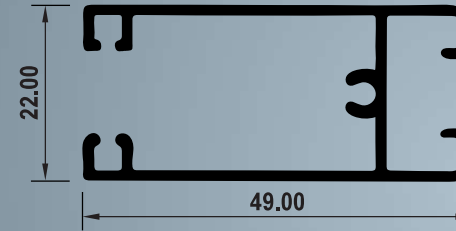

SECTION NO.: PI - 78-4

Weight: 1.440-1.550 kg / 12'

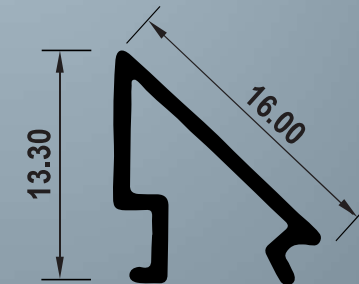

SECTION NO.: PI - 78-5

Weight: 0.190-0.210 kg / 12'

TWO TRACK

SECTION NO.: PI - 852
Weight: 0.870-0.970 kg / M
4.500-4.800 Kg/16'

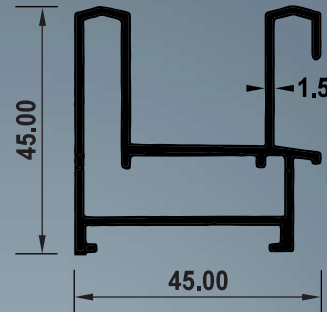

78 SERIES

SECTION NO.: PI - 78 - 1
Weight: 1.800-1.900 kg / 12'

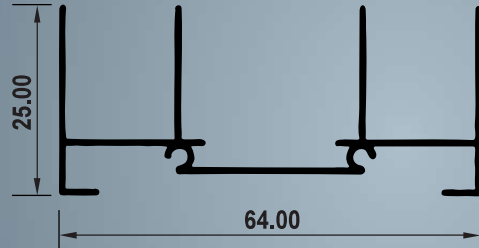

SECTION NO.: PI - 78 - 2
Weight: 3.200-3.300 kg / 12'

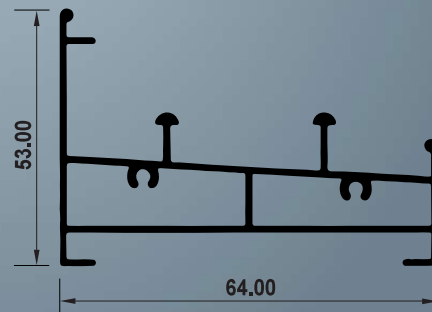



भारत सरकार
Government of India
सूक्ष्म, लघु एवं मध्यम उद्यम मंत्रालय
Ministry of Micro, Small and Medium Enterprises



UDYAM REGISTRATION CERTIFICATE



Our small hands to make you LARGE

UDYAM REGISTRATION NUMBER	UDYAM-WB-10-001249				
NAME OF ENTERPRISE	M/S PRISTINO INDUSTRIES				
TYPE OF ENTERPRISE *	SMALL (Based on FY 2018-19) (MICRO Based FY 2015-16)				
MAJOR ACTIVITY	MANUFACTURING				
SOCIAL CATEGORY OF ENTREPRENEUR	GENERAL				
NAME OF UNIT(S)	S.No. Name of Unit(s) 1. M/S PRISTINO INDUSTRIES				
OFFICIAL ADDRESS OF ENTERPRISE	Plot/Block No.	ESTABLISHMENT TITLE	Name of Premises Building	TRE Locode	
	Village/Town	KOLKATA	Block	KOLKATA	
	Road/Street/Lane	STRAND ROAD	City	KOLKATA	
	State	WEST BENGAL	District	KOLKATA - Pin 700011	
	Pincode	700119/901	Email	info@pristino.com	
DATE OF INCORPORATION / REGISTRATION OF ENTERPRISE	15/07/2019				
DATE OF COMMENCEMENT OF PRODUCTION/BUSINESS					
NATIONAL INDUSTRY CLASSIFICATION CODE(S)	S.No.	NIC 2 Digit	NIC 4 Digit	NIC 5 Digit	Activity
	1	32 - Other manufacturing	3299 - Other manufacturing (a.e.c.)	32991 - Manufacture of other articles (a.e.c.)	Manufacturing
DATE OF UDYAM REGISTRATION	31/08/2019				

* In case of graduation (upward movement) of status of an enterprise, the benefits of the Government Schemes will be availed as per the provisions of Notification No. RD. 21191 dated 26.06.2018 issued by the MSME.

Disclaimer: This is computer generated document, no signature required. Printed from <http://udyamregistration.gov.in> @ Date of printing: 09/02/2019

For any assistance, you may contact:

- District Industries Centre: KOLKATA (WEST BENGAL)
- MSME-DFO: KOLKATA (WEST BENGAL)

Mail: www.misra.gov.in ; www.dfo.msme.gov.in ; www.championline.gov.in

Follow us @ [@minname](https://twitter.com/minname) & [@iamchampionline](https://twitter.com/iamchampionline)



BE A
CHAMPION
with the
Ministry of
MSME

OUR TEAM

ABHISHEK SHARAD

Mr. Abhishek Sharad aged about 43 years has passed his LLB and LLM. Having keen knowledge in legal front he adds great value to which ever organisation he associates himself with. Moreover, he has been working in real estate sector for the past ten years which makes him a perfect candidate to build a business from ground up.

MAHESH KUMAR SARAF

Mr. Mahesh Kumar Saraf, a commerce graduate is having experience of 35 years of business. M/s Saraf Silicates, Aditi R&D Services, Vaishnavi Polycoates are the business Firms which tells the story of his dynamic managing & leadership capabilities. He started his Aluminium journey back in 2012 with the formation of Sterile Extrusions Pvt Ltd. Under his leadership Sterile Extrusions has grown to be a recognized name in the field of Aluminium extrusions products in Eastern India.

SURESH BARALIA

Mr. Suresh Baralia aged about 56 years, a commerce graduate, having a work experience of more than 36 years. He stated his carrier way back in 1984 with FMCG products and worked his way through different sectors ranging from Civil construction, to home appliances to LIC financial advisor. He jumped ship to manufacturing sector in 2010 with iron slag crusher units in Hyderabad, Goa and Chennai and has been working in manufacturing sector since. Having immense knowledge of finance and accounts, he brings with himself such unmatched expertise which can help any organization to sore great heights.

DOMAL / EURO SERIES

27 MM EURO SLIDING

INTERLOCK CLIP

SECTION NO.: PI - 855

Weight: 0.330 kg / M

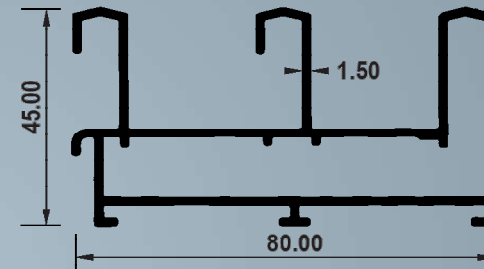
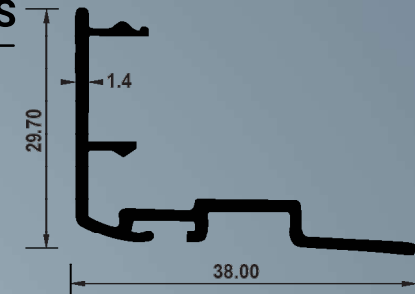

THREE TRACK

SECTION NO.: PI - 851

Weight: 1.400 kg / M
6.7-7.1 kg / 16'

SINGLE SHUTTER

SECTION NO.: PI - 854

Weight: 0.79 kg / M
3.9-4.2 kg / 16'

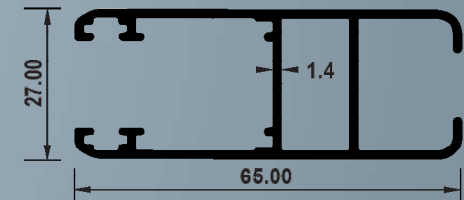

FOUR TRACK

SECTION NO.: PI - 853

Weight: 6.800-6.900 kg / 12'
9-9.5 kg / 16'

SOLAR FRAME

SEC. NO.	A	B	Wt. Range (Kg / M)
PI-912	25.00	25.00	0.21

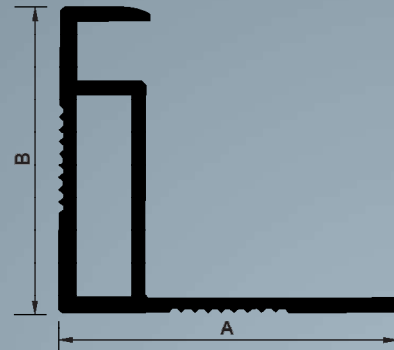

SOLAR FRAME

SEC. NO.	A	B	Wt. Range (Kg / 12ft)
PI-913	35.00	35.00	1.522-1.622

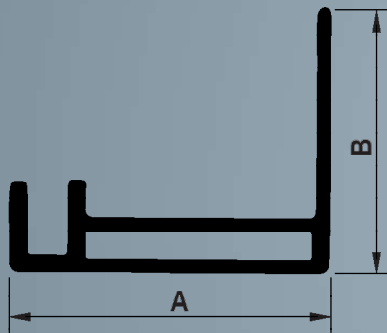

SOLAR FRAME

SEC. NO.	A	B	Wt. Range (Kg / 12ft)
PI-914	35.00	30.00	

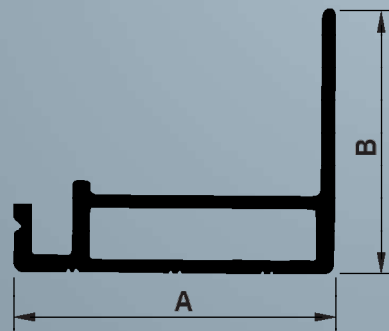

PRAVIN KUMAR CHAND

Mr. Pravin Kumar Chand aged about 52 years is a graduate from Kolkata university. His professional career expands for more than 3 decades and has expertise in many different fields. He has been working in aluminium related industry for the past 5 years.

VIKASH AGARWAL

Mr. Vikash Agarwal aged about 37 years is a graduate (Bachelor of Business Management) from Alliance Business Academy, Bangalore. He has experience working with multinational company Xchanging Solutions Limited (Formerly Cambridge Solutions Limited) of about 4.6 years as Team Lead Sales and Business Development. He has carried out wholesale and retail sale of Aluminium Extrusion for 4 years catering to North Bengal, Sikkim and Bhutan.

AMIT KANDHARI

Mr. Amit Kandhari aged about 42 years is a graduate in accounts honors from Calcutta university, started his professional career in the year 1998, when the Ferrous industry was booming. He started with refractory manufacturing and upgraded himself very shortly to iron and steel manufacturing. Having worked in the iron industry for nearly 2 decades he shifted to Aluminium sector under the name of Sterile Extrusions Pvt Ltd in the year 2018 and has never looked back since.

PIYUSH GHOSH

Mr. Piyush Ghosh aged about 28 years has passed his Higher Secondary form Kolkata university. He has experience working in aluminium industry for the past 10 years both in smelting and Trading front.

SPECIAL FEATURES OF ALUMINIUM DOORS, WINDOWS, PARTITIONS AND GAZING PROFILES

- AFFORDABILITY**

One benefit of aluminium windows is that they can be significantly cheaper than other window frames. For example, wooden frames such as timber can cost a lot more than aluminium windows and require attentive maintenance.

- DURABILITY**

Aluminium windows have can last up to 30 years. This is because, aluminium is considerably more resistant to the outside elements compared to other frames, making them less likely to warp or rot as a result. Aluminium also has a high strength-to-weight ratio, making them harder to dent.

- EASY TO MAINTAIN**

While also being durable, aluminium windows have the added advantage of being easy to maintain. Different finishes may require more care than other, but overall a quick clean of the glass and frame every 2-4 months will help remove dirt and keep the windows looking shiny.

- SUITABILITY FOR MANY DESIGNS**

Due to how aluminium is manufactured, these windows can easily meet your exact design specifications while maintaining the inherent strength of the material. Furthermore, there is a large variety of customisations from glassing options to finishes in a wide range of colours.

- ECO FRIENDLY**

Aluminium is also a fully sustainable product. It's 100% recyclable and non-toxic, leaving a minimal ecological footprint. Recycling aluminium itself requires just five per cent of the initial energy consumed to create it

- » Light in weight.
- » No risk of adhesion failure.
- » No possibility of fading.
- » Uniform surface finish.
- » Highly impermeable anodic coating layer.
- » Abrasion resistance.

- MINIMUM ORDER:**

Our minimum accepted order quantity is 300 Kg against each section / profile.

- STANDARD LENGTH:**

Material is supplied in standard length of 3.660 meter (12 Ft.). On customer's request, specific custom lengths i.e. 1.00 meter to 6.00 meter (Max.) can also be supplied. It would be finalised prior to order booking.

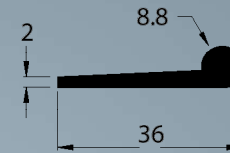

Ladder Hinge

SECTION NO.: PI - 501

Weight: 1.200-1.400 kg / 12'

SOLAR SECTION

SOLAR CORNER

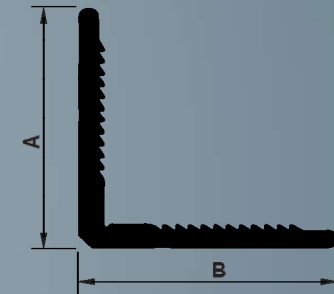

SEC. NO.	A	B	Wt. Range (Kg / 12ft)
PI-901	40.20	40.20	2.500-2.600

SOLAR FRAME

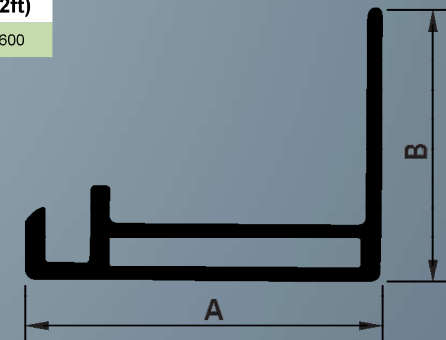

SEC. NO.	A	B	Wt. Range (Kg / 12ft)

FLUTED ROUND TUBE

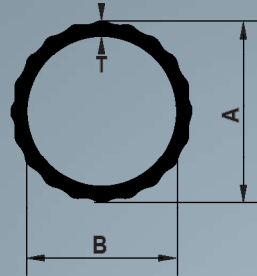

SEC. NO.	A	B	T	Wt. Range (Kg / 12ft)
PI-521	24,80	20,80	2,00	1.150-1.350
PI-522	24,80	20,80	2,20	1.400-1.600

STEP LADDER

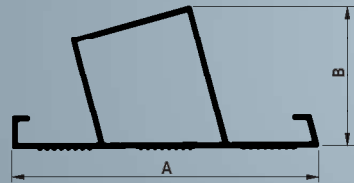

SEC. NO.	A	B	T	Wt. Range (Kg / 12ft)
PI-510	65,50	25,40	1,25	1.200-1.400
PI-511	65,50	25,40	1,50	1.600-1.800

C LADDER

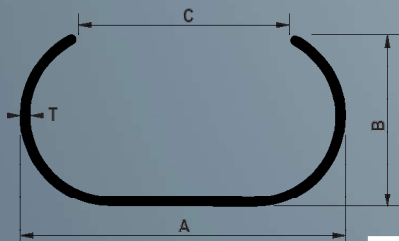

SEC. NO.	A	B	C	T	Wt. Range (Kg / 12ft)
PI-490	66,00	31,50	40,00	1,10	1.100-1.400
PI-491	66,00	31,50	40,00	1,10	1.600-1.800
PI-492	66,00	31,50	40,00	2,00	2.000-2.300
PI-493	66,00	31,50	40,00	2,50	2.500-2.800

HOW TO ORDER:

While placing your order, kindly provide the following details, so that; we can serve you better.

- » Section No. / Die No.
- » Alloy and Temper
- » Cut Length (In mm or Ft.)
- » Quantity (in kg)
- » Packing (Standard Packing): HDPE cloth.
- » Specialized packing can be provided as per customer's specification.
- » End Use

ORDERING FORMAT:

Sr. No.	Section / Die No.	Section Description	Alloy Temper	Cut Length (meter / ft)	Quantity (kg)	Anodising (Yes/No)

Besides the profiles presented in our catalogue, we also manufacture custom made profiles as per our customer's requirements

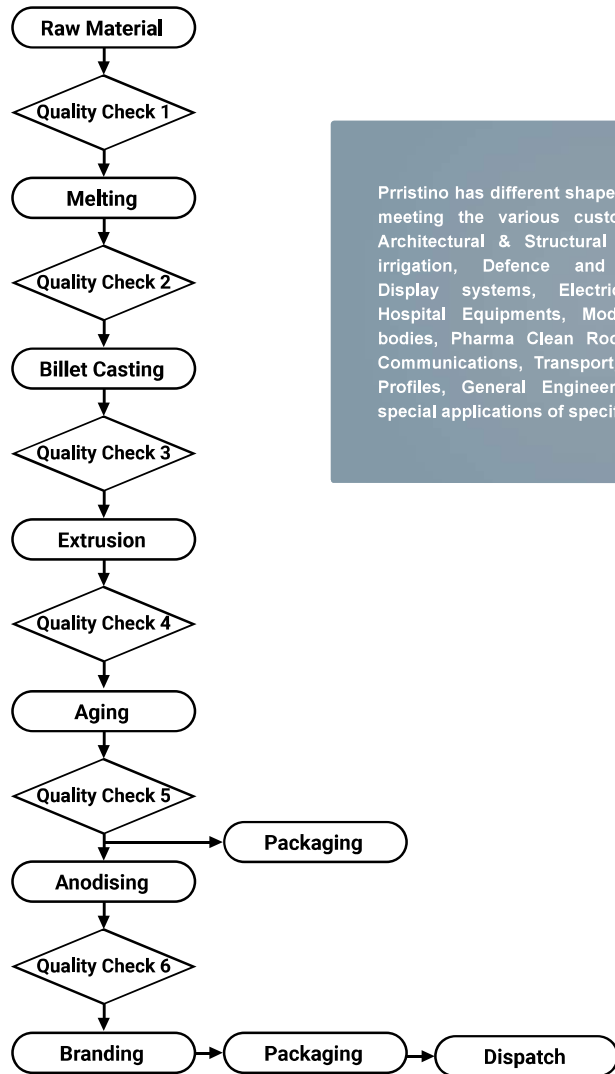

Pristino has different shapes and sizes of profiles meeting the various customers' requirement of Architectural & Structural glazing, air handling, irrigation, Defence and Govt. Organization, Display systems, Electrical and Electronics, Hospital Equipments, Modular Furniture, Motor bodies, Pharma Clean Rooms, Pneumatics, Tele Communications, Transport, Mobile Shelter, Solar Profiles, General Engineering and Tailor made special applications of specific requirements etc.

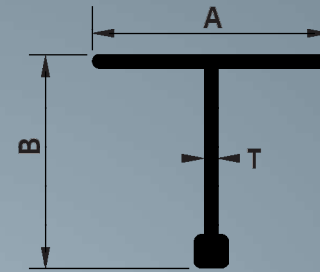

BULB TEE

SEC. NO.	A	B	T	Wt. Range (Kg / 12ft)
PI-371	25.00	25.00	0.72	0.400-0.500
PI-371-1	25.00	25.00	1.00	0.700-0.800
PI-372	25.40	38.10	1.39	0.900-1.100

GLAZING CLIP

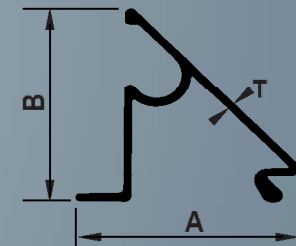

SEC. NO.	A	B	T	Wt. Range (Kg / 12ft)
PI-321	18.40	17.00	0.52	0.220-0.250
PI-322	18.40	17.00	0.60	0.250-0.280
PI-323	18.40	17.00	0.72	0.300-0.330

DOUBLE GLASS CHANNEL

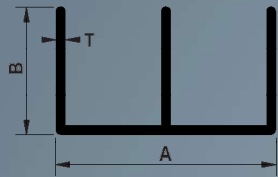

SEC. NO.	A	B	T	Wt. Range (Kg / 12ft)
PI-711	19.00	12.00	0.63	0.350-0.400
PI-712	19.00	12.00	0.95	0.500-0.550
PI-713	22.00	12.00	0.63	0.350-0.400
PI-714	22.00	12.00	0.85	0.450-0.500
PI-715	22.00	12.00	0.95	0.500-0.550
PI-716	22.00	12.00	1.20	0.650-0.700
PI-717	30.00	12.00	1.05	0.650-0.700

PLAIN TEE

SEC. NO.	A	B	T	Wt. Range (Kg / 12ft)
PI-374	25.40	25.40	1.13	0.550-0.600

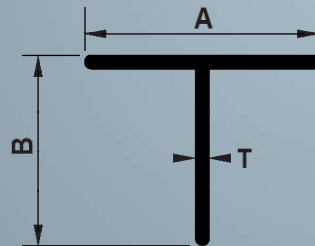

AA 1050 ≈ IS 19500

CHEMICAL COMPOSITION		
Elements	1050 Alloy (%)	19500 Alloy (%)
Cu	0.05 (Max)	0.05 (Max)
Mn	0.05 (Max)	0.05 (Max)
Si	0.25 (Max)	0.30 (Max)
Mg	0.05 (Max)	0.05 (Max)
Fe	0.40 (Max)	0.40 (Max)
Zn	0.05 (Max)	0.05 (Max)
Ti	0.03 (Max)	0.03 (Max)
Cr	--	--
Ni	--	--
Others		
Aluminium	99.50 (Min)	99.50 (Min)

MECHANICAL PROPERTIES			
Physical Properties	1050 Alloy Temper Designation 'O'	19500 Alloy Temper Designation 'O'	19500 Alloy Temper Designation 'F'
UTS (kgf/mm ²)	8 (Typ.)	10 (Max)	6 (Max)
Y. S. (kgf/mm ²) / 0.2% P. S. (kgf/mm ²)	3 (Typ.)	NA	2 (Min)

APPLICATION OF ALLOY

Mother Tubes (Blooms) for producing Engineering products by cold working methods such as drawing, forming etc.

AA 1100 ~ IS 19000

CHEMICAL COMPOSITION

Elements	1100 Alloy (%)	19000 Alloy (%)
Cu	0.05 - 0.20	0.10 (Max)
Mn	0.05 (Max)	0.10 (Max)
Si	0.50 (Max)	0.50 (Max)
Fe	0.50 (Max)	0.60 (Max)
Others	Each 0,05 (Max) Total 0.15 (Max)	Each 0,05 (Max) Total 0.15 (Max)

MECHANICAL PROPERTIES

Physical Properties	1100 Alloy Temper Designation 'O'	19000 Alloy Temper Designation 'O'	19000 Alloy Temper Designation 'F'
UTS (kgf/mm ²)	11 (Typ.)	11 (Max)	6 (Max)
% Elongation	25 (Typ.)	25 (Min)	18 (Min)

APPLICATION OF ALLOY

Applications requiring good formability and high resistance to corrosion where high strength is not necessary. Food and brewing industrial packaging, cooking utensils, architectural and builder's hardware, deep drawn parts, welding wire, cladding, electrical applications.

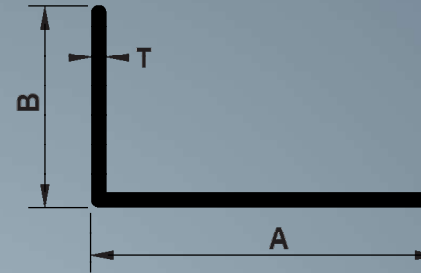

UNEQUAL ANGLE

SEC. NO.	A	B	T	Wt. Range (Kg / 12ft)
PI-343	38.00	25.40	1.5	1.600-1.750
PI-343-1	38.00	25.40	1.7	1.800-2.000
PI-346	50.00	25.40	1.2	1.500-1.700

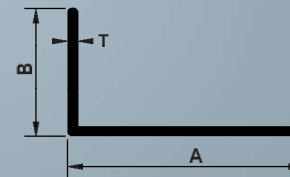

SINGLE GLASS CHANNEL

SEC. NO.	A	B	T	Wt. Range (Kg / 12ft)
PI-701	9.00	9.00	0.60	0.150-0.200
PI-702	9.00	9.00	0.80	0.200-0.250
PI-703	12.00	12.00	0.75	0.250-0.300
PI-704	12.00	12.00	1.05	0.350-0.400
PI-705	15.00	12.00	0.9	0.350-0.400
PI-706	19.00	12.00	1.15	0.450-0.500
PI-707	25.00	12.00	1.45	0.650-0.750
PI-708	38.00	25.00	1.80	1.500-1.700

GLAZING PLATE

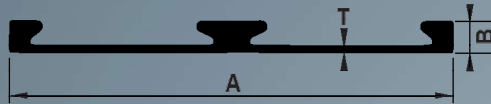

SEC. NO.	A	B	T	Wt. Range (Kg / 12ft)
PI-381	44.45	3.00	0.60	0.500-0.600
PI-382	44.45	3.00	0.70	0.600-0.800

EQUAL ANGLE

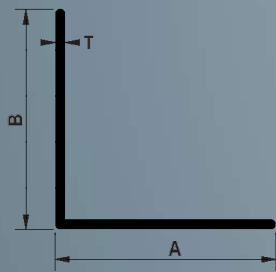

SEC. NO.	A	B	T	Wt. Range (Kg / 12ft)
PI-341	19.00	19.00	0.8	0.450-0.500
PI-342	25.45	25.45	0.8	0.400-0.500
PI-342-1	25.45	25.45		0.750-0.850
PI-344	38.00	38.00		1.100-1.300
PI-345	38.00	38.00		3.600-4.000

AA 1350 ~ IS 19501

CHEMICAL COMPOSITION

Elements	1350 Alloy (%)	19501 Alloy (%)
Cu	0.05 (Max)	0.04 (Max)
Mn	0.01 (Max)	0.02 (Max)
Si	0.10 (Max)	0.15 (Max)
Fe	0.40 (Max)	0.30 (Max)
Zn	0.05 (Max)	0.02 (Max)
Cr	0.01 (Max)	0.02 (Max)
Others	Each 0.03 (Max) Total 0.10 (Max)	Each 0.03 (Max) Total 0.10 (Max)
Aluminium	99.50 (Min)	99.50 (Min)

MECHANICAL PROPERTIES

Physical Properties	1350 Alloy Temper Designation 'O'	19501 Alloy Temper Designation 'F'
UTS (kgf/mm ²)	8 (Typ.)	6 (Min)
Y. S. (kgf/mm ²) / 0.2% P. S. (kgf/mm ²)	3 (Typ.)	NA
% Elongation	23 (Typ.)	25 (Min)
Electrical Conductivity %IACS	61 (Min)	60 (Min)

APPLICATION OF ALLOY

Wires, electrical conductors, Bus Bars, Cable Sheathing, Impact Extruded Products, Transformer Strips, Lugs etc.

AA 5052 ≈ IS 52000

CHEMICAL COMPOSITION

Elements	5052 Alloy (%)	52000 Alloy (%)
Cu	0.10 (Max)	0.10 (Max)
Mn	0.10 (Max)	0.50 (Max)
Si	0.25 (Max)	0.60 (Max)
Mg	2.20 - 2.80	1.70 - 2.60
Fe	0.40 (Max)	0.50 (Max)
Zn	0.10 (Max)	0.20 (Max)
Cr	0.15 - 0.35	0.25 (Max)
Ni	--	--
Others	Each 0.05 (Max) Total 0.15 (Max)	Each 0.05 (Max) Total 0.15 (Max)
Remainder	Aluminium	Aluminium

MECHANICAL PROPERTIES

Physical Properties	5052 Alloy Temper Designation 'O'	52000 Alloy Temper Designation 'O'	52000 Alloy Temper Designation 'F'
UTS (kg/mm ²)	24 (Typ.)	10 (Max)	6 (Max)
% Elongation	18 (Typ.)	25 (Min)	23 (Min)
Hardness (BHN)	40 (Typ.)	40 (Typ.)	45 (Typ.)

APPLICATION OF ALLOY

Structures exposed to marine atmosphere, aircraft parts, wire rope ferrules, river stock etc where good durability, very good resistance to corrosion, high fatigue strength, weld ability and moderate static strengths are desired.

PLAIN ROUND TUBE

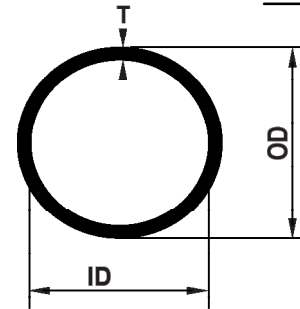

SEC. NO.	OD	T	Wt. Range (Kg / 12ft)
PI-770	19.00	1.50	0.500-0.700
PI-771	19.00	1.60	0.900-1.000
PI-772	22.00	3.15	0.700-0.880
PI-773	22.00	1.55	1.000-1.100
PI-774	30.00	1.00	0.900-1.000

SEC. NO.	A	T	Wt. Range (Kg / 12ft)
----------	---	---	--------------------------

PI-550	25.00	1.00	0.245
PI-551	25.00	3.00	0.740
PI-552	25.00	5.00	1.200
PI-553	25.00	6.00	1.500
PI-554	25.00	10.00	2.500
PI-555	25.40	5.50	1.250
PI-556	25.40	10.00	2.400
PI-557	28.00	6.00	1.650
PI-558	35.00	3.00	1.036
PI-559	40.00	6.00	2.400
PI-560	40.00	10.00	2.400
PI-561	50.00	3.00	1.500
PI-562	50.00	5.00	2.500
PI-563	50.00	6.00	3.000
PI-564	50.00	10.00	4.950
PI-565	60.00	10.00	5.800
PI-566	63.00	12.00	7.500
PI-567	75.00	5.00	3.750
PI-568	75.00	6.00	4.450
PI-569	75.00	10.00	7.500
PI-570	75.00	12.00	8.900
PI-571	100.00	10.00	9.900
PI-572	100.00	11.00	10.900
PI-573	100.00	12.00	11.800

FLAT BAR

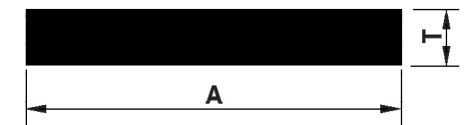

63 X 38 WOODEN CHOUKHAT

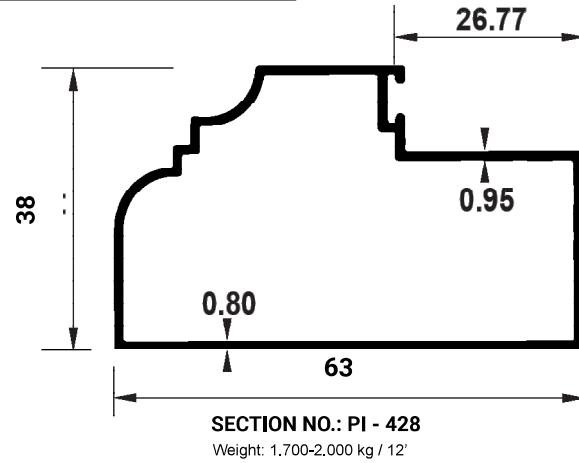

G SECTION

SEC. NO.	Wt. Range (Kg / 12ft)
PI-245	2.000-2.400

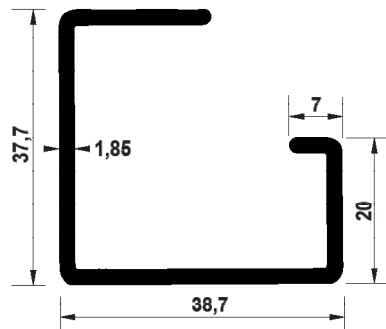

AA 6005 and 6005A

CHEMICAL COMPOSITION

Elements	6005 Alloy (%)	6005A Alloy (%)
Si	0.60-0.90	0.50-0.90
Mg	0.40-0.60	0.40-0.70
Fe	0.35 (Max)	0.35 (Max)
Mn	0.10 (Max)	0.50 (Max)
Cu	0.10 (Max)	0.30 (Max)
Zn	0.10 (Max)	0.20 (Max)
Ti	0.10 (Max)	0.10 (Max)
Cr	0.10 (Max)	0.30 (Max)
Others	Each 0.05 (Max) Total 0.15 (Max)	Each 0.05 (Max) Total 0.15 (Max)
Remainder	Aluminium	Aluminium

MECHANICAL PROPERTIES

Physical Properties	Alloy 6005	Alloy 6005A
	Temper Designation	Temper Designation
	T5	T6
UTS (kgf/mm ²)	26 (Min)	26 (Min)
Y. S. (kgf/mm ²) / 0.2% P. S. (kgf/mm ²)	24 (Min)	22 (Min)
% Elongation	8 (Min)	7 (Min)

APPLICATION OF ALLOY

It is used for commercial applications where strength requirements is greater than those of 6063 alloy. It is used in ladder profiles.

AA 6063 ≈ IS 63400

CHEMICAL COMPOSITION

Elements	6063 Alloy (%)	63400 Alloy (%)
Cu	0.10 (Max)	0.10 (Max)
Mn	0.10 (Max)	0.30 (Max)
Si	0.20 - 0.60	0.30 - 0.70
Mg	0.45 - 0.90	0.45 - 0.90
Fe	0.35 (Max)	0.60 (Max)
Zn	0.10 (Max)	0.02 (Max)
Ti	0.10 (Max)	0.20 (Max)
Cr	0.10 (Max)	0.25 (Max)
Others	Each 0.05 (Max) Total 0.15 (Max)	Each 0.05 (Max) Total 0.15 (Max)
Remainder	Aluminium	Aluminium

MECHANICAL PROPERTIES

Physical Properties	Alloy 6063			Alloy 63400			
	Temper Designation			Temper Designation			
	O	T4	T6	O	F	W	WP
UTS (kgf/mm ²)	13 (Max)	13 (Min)	24 (Min)	13 (Max)	11 (Min)	14 (Min)	19 (Min)
Y. S. (kgf/mm ²) / 0.2% P. S. (kgf/mm ²)	NA	9 (Min)	17 (Min)	NA	NA	8 (Min)	15 (Min)
% Elongation	18 (Min)	14 (Min)	8 (Min)	18 (Min)	13 (Min)	13 (Min)	6 (Min)
Hardness (BHN)	35 (Max)	45 (Typ)	60 (Typ)	35 (Max)	35 (Max)	45 (Typ)	

APPLICATION OF ALLOY

Building hardware, architectural sections with good surface finish, medium strength furniture and other applications where surface finish is important and medium strength will surface.

SECTION NO.: PI - 750

Weight: 0.220-0.270 kg / 12'

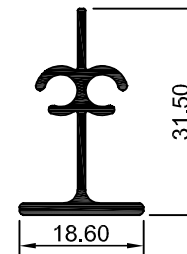
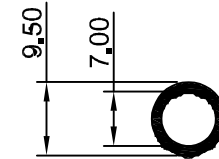

SECTION NO.: PI - 751

Weight: 1.000-1.100 kg / 12'

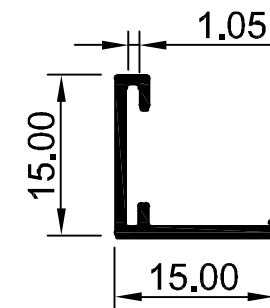

SECTION NO.: PI - 752

Weight: 0.330-0.400 kg / 12'



SECTION NO.: PI - 746
Weight: 0.200-0.250 kg / 12'

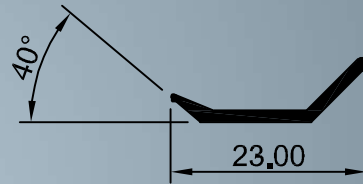

SECTION NO.: PI - 747
Weight: 0.320-0.380 kg / 12'

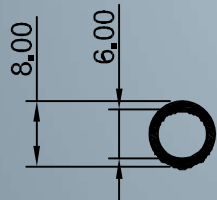

SECTION NO.: PI - 748
Weight: 0.220-0.270 kg / 12'

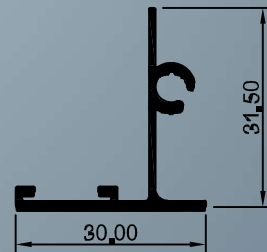

SECTION NO.: PI - 749
Weight: 0.850-0.950 kg / 12'

AA 6082

CHEMICAL COMPOSITION

Elements	6082 Alloy (%)
Si	0.70-1.30
Mg	0.60-1.20
Mn	0.40-1.00
Fe	0.50 (Max)
Cr	0.25 (Max)
Zn	0.20 (Max)
Cu	0.10 (Max)
Ti	0.10 (Max)
Others	Each 0.05 (Max) Total 0.15 (Max)
Remainder	Aluminium

MECHANICAL PROPERTIES

Physical Properties	6082 Alloy Temper Designation T6
UTS (kgf/mm ²)	31 (Min)
Y. S. (kgf/mm ²) / 0.2% P. S. (kgf/mm ²)	26 (Min)
% Elongation	6 (Min)
Hardness (BHN)	90 (Typ)

APPLICATION OF ALLOY

It is used for structural and general engineering items such as rail, road transport, vehicles, bridges, cranes, roof trusses, rivets, gear pump casing etc.

AA 6061 ≈ IS 65032

CHEMICAL COMPOSITION

Elements	6061 Alloy (%)	65032 Alloy (%)
Cu	0.40 (Max)	0.15 - 0.40
Mn	0.15 (Max)	0.20 - 0.80
Si	0.40 - 0.80	0.40 - 0.80
Mg	0.80 - 1.20	0.70 - 1.20
Fe	0.70 (Max)	0.70 (Max)
Zn	0.25 (Max)	0.20 (Max)
Ti	0.15 (Max)	0.20 (Max)
Cr	0.04 - 0.35	0.15 - 0.35
Others	Each 0.05 (Max) Total 0.15 (Max)	Each 0.05 (Max) Total 0.15 (Max)
Remainder	Aluminium	Aluminium

MECHANICAL PROPERTIES

Physical Properties	Alloy 6061			Alloy 65032			
	Temper Designation			Temper Designation			
	O	T4	T6	O	F	W	WP
UTS (kgf/mm ²)	15 (Max)	18 (Min)	26 (Min)	15 (Max)	11 (Min)	17 (Min)	25 (Min)
Y. S. (kgf/mm ²) / 0.2% P. S. (kgf/mm ²)	11	11 (Min)	24 (Min)	11 (Max)	5 (Min)	11 (Min)	20 (Min)
% Elongation	16 (Min)	16 (Min)	8 (Min)	16 (Min)	12 (Min)	12 (Min)	6 (Min)
Hardness (BHN)	35 (Max)	35 (Typ)	85 (Typ)	35 (Max)	35 (Max)	55 (Typ)	85 (Typ)

APPLICATION OF ALLOY

Heavy Duty Structural applications of all kinds such as road and rail transport vehicles, bridges, cranes, roof trusses, rivets etc.

AIR GRILL / DIFUSER / LOUVER SECTION

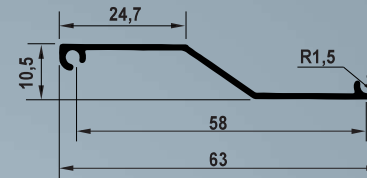

SECTION NO.: PI - 741

Weight: 0.810 kg / 12'

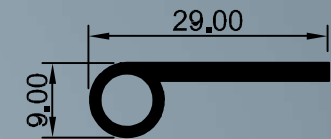

SECTION NO.: PI - 742

Weight: 0.750-0.850 kg / 12'

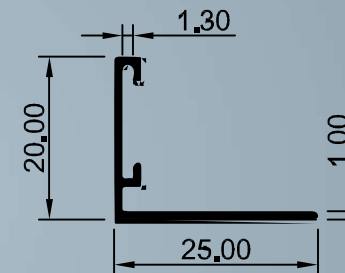

SECTION NO.: PI - 743

Weight: 0.550-0.600 kg / 12'

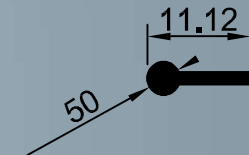

SECTION NO.: PI - 744

Weight: 0.280-0.350 kg / 12'

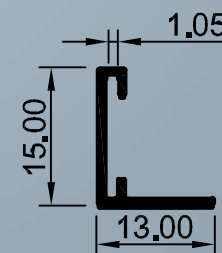

SECTION NO.: PI - 745

Weight: 0.320-0.350 kg / 12'

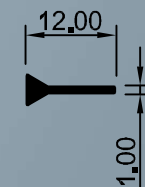

SECTION NO.: PI - 746

Weight: 0.200-0.250 kg / 12'

40 MM SERIES OUTER FRAME

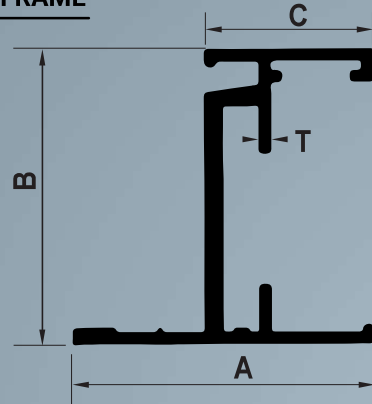

SEC. NO.	A	B	C	T	Wt. Range (Kg / 12ft)
PI-335	41.00	40.00	22.60	1.40	1.700-1.900
PI-336	41.00	40.00	22.70	1.10	2.100-2.300

40 MM SERIES G CLIP

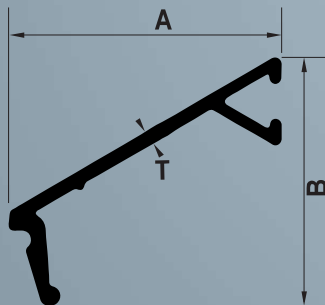

SEC. NO.	A	B	T	Wt. Range (Kg / 12ft)
PI-339	25.30	23.00	1.20	0.550-0.650

AA 6101 ≈ IS 63401

CHEMICAL COMPOSITION

Elements	6101 Alloy (%)	63401 Alloy (%)
Cu	0.10 (Max)	0.05 (Max)
Mn	0.03 (Max)	0.03 (Max)
Si	0.30 - 0.70	0.30 - 0.70
Mg	0.35 - 0.80	0.40 - 0.90
Fe	0.50 (Max)	0.50 (Max)
Zn	0.10 (Max)	0.10 (Max)
Ti	0.03 (Max)	0.10 (Max)
Cr	0.03 (Max)	0.03 (Max)
Others	Each 0.03 (Max) Total 0.10 (Max)	Each 0.03 (Max) Total 0.15 (Max)
Remainder	Aluminium	Aluminium

MECHANICAL PROPERTIES

Physical Properties	Alloy Temper				
	6101		63401		
	T4	T6	W	WP (Range 1)	WP (Range 2)
UTS (kgf/mm ²)	15 (Min)	19 (Min)	14 (Min)	17 (Min)	20 (Min)
Y. S. (kgf/mm ²) / 0.2% P. S. (kgf/mm ²)	9 (Min)	15 (Min)	8 (Min)	13 (Min)	17 (Min)
% Elongation	12 (Min)	12 (Min)	12 (Min)	12 (Min)	10 (Min)
Electrical Conductivity (%IACS)	NA	56 (Min)	NA	56 (Typ)	55 (Min)

APPLICATION OF ALLOY

High strength Bus Bars, electrical conductors, Heat Sinks etc.

AA 6351 ~ IS 64430

CHEMICAL COMPOSITION		
Elements	6351 Alloy (%)	64430 Alloy (%)
Cu	0.10 (Max)	0.10 (Max)
Mn	0.40 - 0.80	0.40 - 1.00
Si	0.70 - 1.30	0.60 - 1.30
Mg	0.40 - 0.80	0.40 - 1.20
Fe	0.50 (Max)	0.60 (Max)
Zn	0.20 (Max)	0.10 (Max)
Ti	0.20 (Max)	0.20 (Max)
Cr	0.50 (Max)	0.25 (Max)
Others	Each 0.03 (Max) Total 0.10 (Max)	Each 0.03 (Max) Total 0.10 (Max)
Remainder	Aluminium	Aluminium

MECHANICAL PROPERTIES						
Physical Properties	Alloy 6351			Alloy 64430		
	Temper Designation			Temper Designation		
	F	T4	T6	F	W	WP
UTS (kgf/mm ²)	11 (Max)	18 (Min)	31 (Min)	11 (Min)	17 (Min)	28 (Min)
Y. S. (kgf/mm ²) / 0.2% P. S. (kgf/mm ²)	8 (Min)	12 (Min)	27 (Min)	8 (Min)	10 (Min)	24 (Min)
% Elongation	12 (Min)	14 (Min)	8 (Min)	12 (Min)	14 (Min)	6 (Min)
Hardness (BHN)	NA	60 (Min)	90 (Min)	NA	60 (Min)	90 (Typ)

APPLICATION OF ALLOY

Structural and general engineering items such as rail and road transport vehicles, bridges, cranes, roof, trusses, rivets, etc

40 MM CASEMENT SERIES

40 MM SERIES MULLION

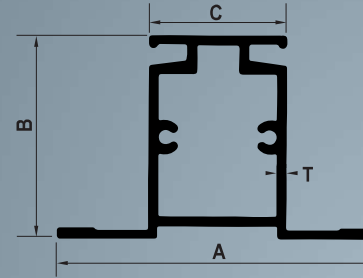

SEC. NO.	A	B	C	T	Wt. Range (Kg / 12ft)
PI-338	63.00	40.00	27.00	1.70	3.300-3.500

40 MM SERIES Z FRAME

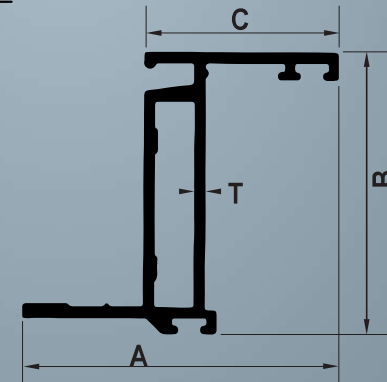

SEC. NO.	A	B	C	T	Wt. Range (Kg / 12ft)
PI-337	47.00	42.00	29.00	1.40	2.200-2.400

ARCHITECTURAL SECTION

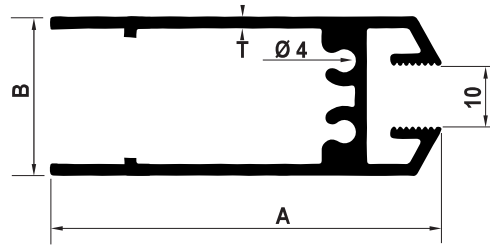

25 MM SERIES - BEARING TOP BOTTOM

SEC. NO.	A	B	T	Wt. Range (Kg / 12ft)
PI-275	69.00	25.40	1.50	3.700-4.000

RECTANGULAR TUBE

Sec. No.	A	B	T	Wt. Range (Kg / 12ft)
PI-353	38.00	25.00	0.80	0.800-1.000
PI-353-1	38.00	25.00	0.95	1.000-1.200
PI-353-2	38.00	25.00	1.10	1.400-1.600
PI-353-3	38.00	25.00	1.50	1.700-1.900
PI-352	50.00	25.00	0.85	1.000-1.200
PI-352-1	50.00	25.00	1.10	1.500-1.700
PI-352-2	50.00	25.00	1.30	1.800-2.000
PI-352-3	50.00	25.00	1.50	2.000-2.200
PI-352-4	50.00	25.00	1.80	2.800-3.000
PI-352-5	50.00	25.00	3.00	3.800-4.000
PI-354	63.00	38.00	0.95	1.500-1.700
PI-354-1	63.00	38.00	1.30	1.900-2.100
PI-354-2	63.00	38.00	1.50	2.400-2.600
PI-354-3	63.00	38.00	1.70	2.800-3.000
PI-354-4	63.00	38.00	2.00	3.800-4.000
PI-354-5	63.00	38.00	3.00	5.400-5.800
PI-355-1	100.00	44.00	1.30	3.800-4.100
PI-360	74.00	19.00	-	3.700-4.000
PI-361	75.00	25.00	-	1.800-2.000
PI-362	100.00	25.00	-	2.000-2.200
PI-362-1	100.00	25.00	-	2.400-2.600
PI-362-2	100.00	25.00	-	5.600-5.900
PI-362-3	100.00	25.00	-	7.300-7.500
PI-363	50.00	19.00	-	2.000-2.300
PI-364	50.00	19.00	-	2.500-2.800
PI-365	75.00	12.00	-	2.000-2.200
PI-365-1	75.00	12.00	-	3.000-3.300

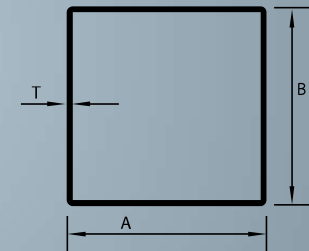
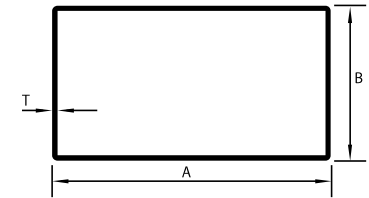

SQUARE TUBE

Sec. No.	A	B	T	Wt. Range (Kg / 12ft)
PI-400	19.00	19.00	0.95	0.650-0.750
PI-401	25.00	25.00	0.90	0.700-0.800
PI-402	50.00	50.00	1.20	2.800-3.700
PI-403	50.00	50.00	1.50	3.300-3.500
PI-404	50.00	50.00	2.00	3.600-4.000
PI-405	50.00	50.00	3.00	5.200-5.500
PI-406	38.00	38.00	1.30	1.800-2.000

Sec. No.	A	B	T	Wt. Range (Kg / 12ft)
PI-001	50.80	25.40	0.95	1.400-1.500
PI-002	50.80	25.40	1.10	1.700-1.800
PI-003	50.80	25.40	1.30	2.100-2.300
PI-004	63.00	38.00	0.95	1.700-1.900
PI-005	63.00	38.00	1.10	2.000-2.200
PI-006	63.00	38.00	1.20	2.400-2.600
PI-007	63.00	38.00	1.50	3.000-3.300
PI-008	63.00	38.00	2.00	3.800-4.000
PI-009	63.00	38.00	3.00	4.800-5.000
PI-010	101.00	44.45	1.20	3.800-4.000
PI-011	101.00	44.45	1.50	4.200-4.500
PI-012	101.00	44.45	2.00	5.400-5.700
PI-013	101.00	44.45	3.00	8.700-9.000

SINGLE PARTITION

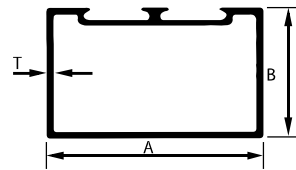

25 MM SERIES - HANDLE

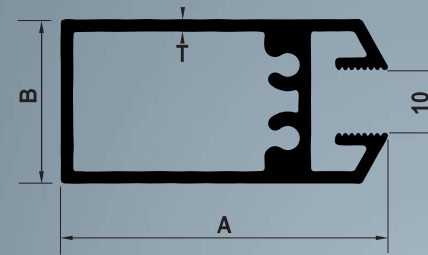

SEC. NO.	A	B	T	Wt. Range (Kg / 12ft)
----------	---	---	---	-----------------------

Sec. No.	A	B	T	Wt. Range (Kg / 12ft)
PI-021	50.80	25.40	0.95	1.400-1.600
PI-022	50.80	25.40	1.10	1.700-1.900
PI-023	50.80	25.40	1.30	2.100-2.300
PI-024	63.00	38.00	1.00	1.700-1.900
PI-025	63.00	38.00	1.10	1.900-2.100
PI-026	63.00	38.00	1.20	2.400-2.600
PI-027	63.00	38.00	1.50	3.000-3.300
PI-028	63.00	38.00	2.00	4.800-5.000
PI-029	63.00	38.00	3.00	5.800-6.000
PI-030	101.00	44.45	1.20	3.800-4.000
PI-031	101.00	44.45	1.50	4.200-4.500
PI-032	101.00	44.45	2.00	5.400-5.700
PI-033	101.00	44.45	3.00	8.800-9.000

DOUBLE PARTITION

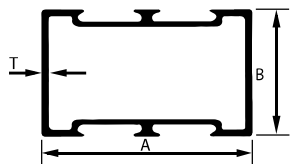

25 MM SERIES - INTERLOCK

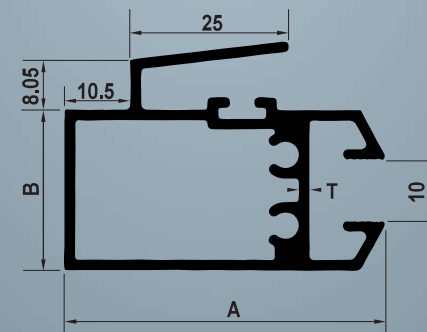

SEC. NO.	A	B	T	Wt. Range (Kg / 12ft)
----------	---	---	---	-----------------------

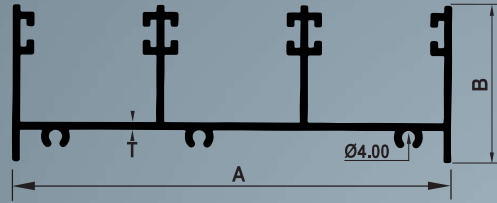

25 MM SERIES - 3 TRACK TOP

SEC. NO.	A	B	T	Wt. Range (Kg / 12ft)
PI-273	123.00	44.00	1.50	5.400-5.600

25 MM SERIES - 3 TRACK BOTTOM

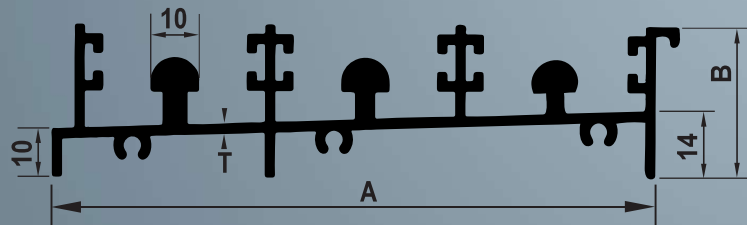

SEC. NO.	A	B	T	Wt. Range (Kg / 12ft)
PI-274	128.00	31.75	1.50	7.500-7.700

DOOR MIDDLE SINGLE

Sec. No.	A	B	T	Wt. Range (Kg / 12ft)
PI-041	47.00	44.45	0.95	2.000-2.200
PI-042	47.00	44.45	1.25	2.900-3.100
PI-043	47.00	44.45	1.50	3.800-4.000

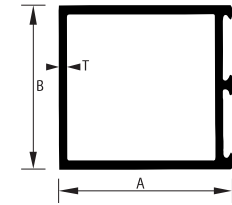

DOOR MIDDLE DOUBLE

Sec. No.	A	B	T	Wt. Range (Kg / 12ft)
PI-061	47.00	44.45	0.95	2.300-2.500
PI-062	47.00	44.45	1.25	2.600-2.800
PI-063	47.00	44.45	1.5	3.300-3.500
PI-071	85.00	85.00	1.5	4.300-4.500
PI-072	100.00	44.45	1.5	5.000-5.300

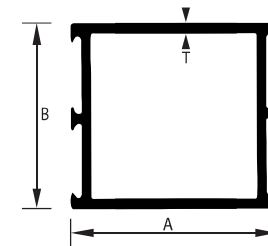

DOOR VERTICAL

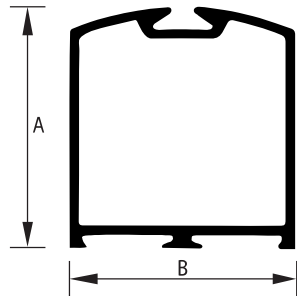

Sec. No.	A	B	Wt. Range (Kg / 14ft)
PI-121	47.00	44.45	2.400-2.600
PI-122	47.00	44.45	2.800-3.000
PI-123	47.00	44.45	3.200-3.500
PI-131	85.00	44.45	4.300-4.500

DOOR TOP

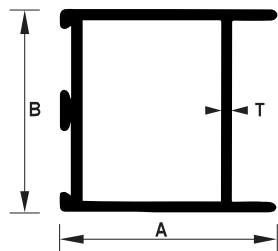

Sec. No.	A	B	T	Wt. Range (Kg / 14ft)
PI-081	47.50	44.45	0.95	2.100-2.300
PI-082	47.50	44.45	1.15	2.600-2.800
PI-083	47.50	44.45	2.00	3.100-3.300
PI-084	47.50	44.45	3.00	3.300-3.500

25 MM SERIES - 2 TRACK TOP

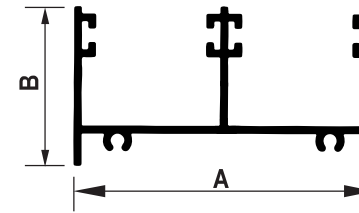

SEC. NO.	A	B	T	Wt. Range (Kg / 12ft)
PI-271	83.00	44.00	2.00	3.700-3.800

25 MM SERIES - 2 TRACK BOTTOM

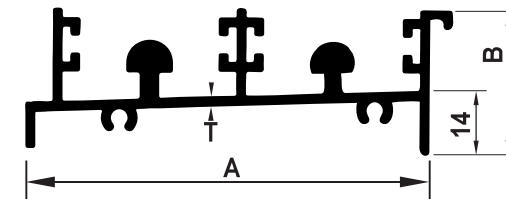

SEC. NO.	A	B	T	Wt. Range (Kg / 12ft)
PI-272	88.00	32.00	1.50	5.300-5.500

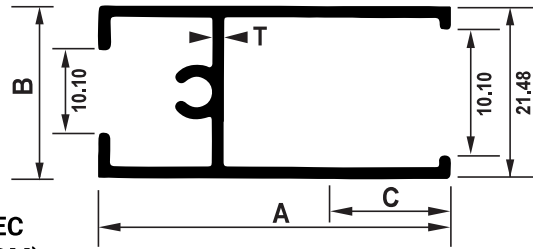

**20MM SERIES - H SEC
(BEARING TOP BOTTOM)**

SEC. NO.	A	B	C	T	Wt. Range (Kg / 12ft)
PI-241	41.00	20.00	13.30	0.90	1.000-1.100
PI-241-1	41.00	20.00	13.30	1.00	1.150-1.250
PI-242	41.00	20.00	13.30	1.20	1.500-1.700
PI-243	41.00	20.00	13.30	1.50	1.700-2.100

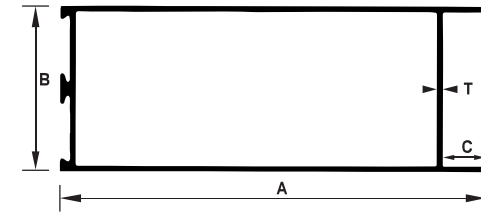

DOOR BOTTOM

SEC. NO.	A	B	C	T	Wt. Range (Kg / 12ft)
PI-101	114.00	44.00	10.0	1.10	4.200-4.400
PI-102	114.00	44.45	25.0	1.40	5.100-5.300
PI-103	100.00	44.45	25.0	1.40	5.000-5.300

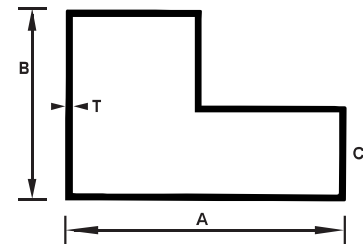

1 1/2 x 1 L TUBE

SEC. NO.	A	B	C	T	Wt. Range (Kg / 12ft)
PI-415	38.00	24.00	12.0	1.00	1.150-1.350
PI-416	38.00	24.00	12.0	1.20	1.500-1.800

**CORNER PARTITION
(PATAM - GUNDI)**

Sec. No.	A	B	T	Wt. Range (Kg / 12ft)
PI-411	63.50	38.00	1.5	3.000-3.500

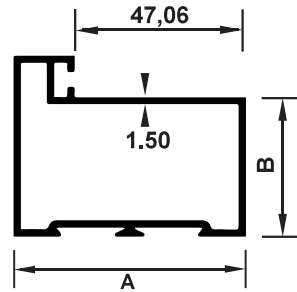

20MM SERIES - SEC A (HANDLE)

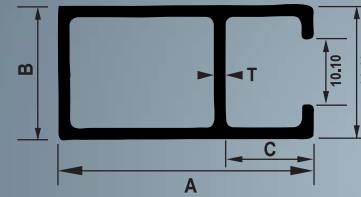

SEC. NO.	A	B	C	T	Wt. Range (Kg / 12ft)
PI-251	39,00	20,00	13,20	0,90	1.000-1.200
PI-251-1	39,00	20,00	13,20	1,00	1.200-1.300
PI-252	39,00	20,00	13,20	1,20	1.500-1.700
PI-253	39,00	20,00	13,20	1,50	1.800-2.000

GLASS SECTION 12mm SOLID

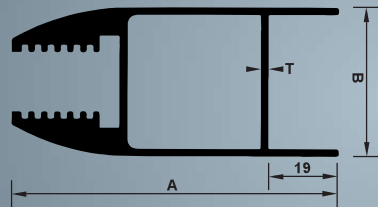

Sec. No.	A	B	T	Wt. Range (Kg / 12ft)
PI-331	90,00	44,00		7.500-8.000

GLASS SECTION 12 MM SOLID

Sec. No.	A	B	T	Wt. Range (Kg / 12ft)
PI-332	40.20	33.00	3.00	6.000-6.200

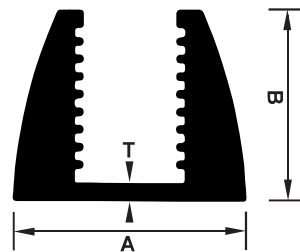

20MM SERIES - INTERLOCK

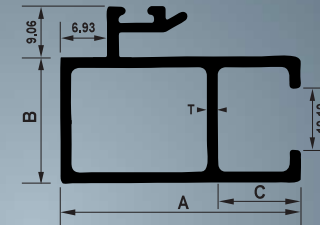

SEC. NO.	A	B	C	T	Wt. Range (Kg / 12ft)
PI-261	39,00	20,00	13,20	0,90	1.200-1.300
PI-261-1	39,00	20,00	13,20	1,00	1.400-1.500
PI-262	39,00	20,00	13,20	1,20	1.600-1.750
PI-263	39,00	20,00	13,20	1,50	2.100-2.300

34 CASEMENT SERIES

20MM SERIES - 3 TRACK TOP

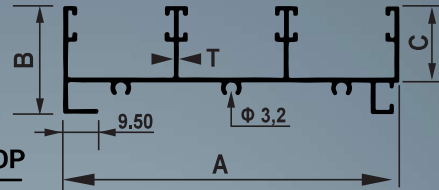

SEC. NO.	A	B	C	T	Wt. Range (Kg / 12ft)
PI-181	92.00	29.50	19.60	0.85	2,200-2,400
PI-181-1	92.00	29.50	19.60	1.00	2,500-2,700
PI-182	92.00	29.50	19.60	1.20	3,000-3,300
PI-183	92.00	29.50	19.60	1.50	3,800-4,200

20MM SERIES - 3 TRACK BOTTOM

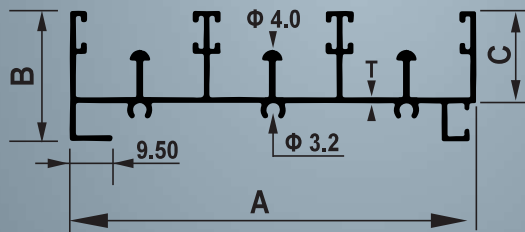

SEC. NO.	A	B	C	T	Wt. Range (Kg / 12ft)
PI-201	92.00	29.50	19.60	0.90	2,400-2,600
PI-201-1	92.00	29.50	19.60	1.00	2,600-2,800
PI-202	92.00	29.50	19.60	1.20	3,200-3,600
PI-203	92.00	29.50	19.60	1.50	4,000-4,500

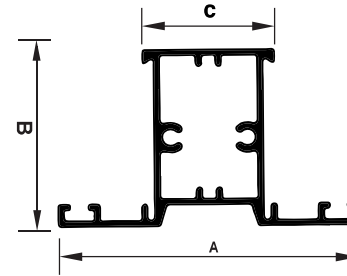

34 SERIES "Z" MULLION

Sec. No.	A	B	C	T	Wt. Range (Kg / 12ft)
PI-297	57.00	34.00			2,300-2,500

34 SERIES Z SECTION

Sec. No.	A	B	C	T	Wt. Range (Kg / 12ft)
PI-294	35.00	28.50			1,800-2,000

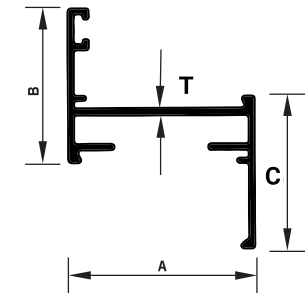

34 SERIES OUTER

Sec. No.	A	B	C	T	Wt. Range (Kg / 12ft)
PI-291	34.00	44.00		1.0	1,400-1,600
PI-292	34.00	44.00		1.5	1,800-2,000

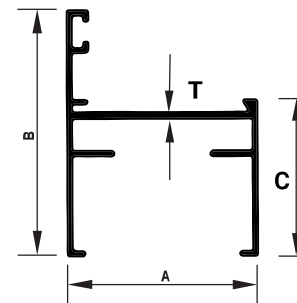

34 SERIES CLIP

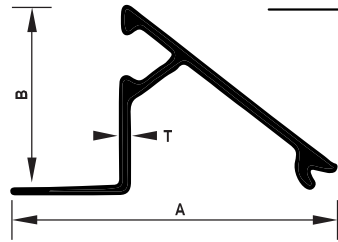

Sec. No.	A	B	T	Wt. Range (Kg / 12ft)
PI-311	31.50	18.20	0.8	0.580-0.650

34 SERIES CLIT ANGLE

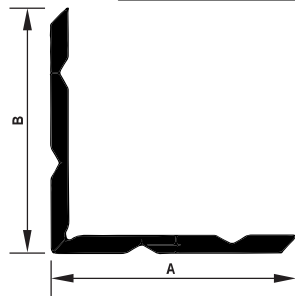

Sec. No.	A	B	Wt. Range (Kg / 12ft)
PI-319	50.00	50.00	3.400

20MM SERIES - 2 TRACK TOP

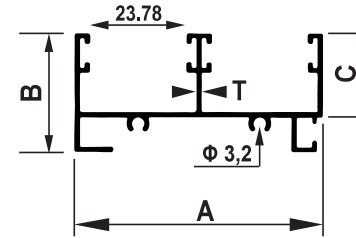

SEC. NO.	A	B	C	T	Wt. Range (Kg / 12ft)
PI-141	62.00	29.50	19.60	0.85	1.400-1.600
PI-141-1	62.00	29.50	19.60	1.00	1.800-2.000
PI-142	62.00	29.50	19.60	1.20	2.200-2.400
PI-143	62.00	29.50	19.60	1.50	2.700-3.000

20MM SERIES - 2 TRACK BOTTOM

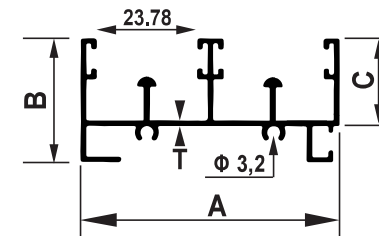

SEC. NO.	A	B	C	T	Wt. Range (Kg / 12ft)
PI-161	62.00	29.50	19.60	0.85	1.600-1.800
PI-161-1	62.00	29.50	19.60	1.00	2.000-2.200
PI-162	62.00	29.50	19.60	1.20	2.300-2.500
PI-163	62.00	29.50	19.60	1.50	2.800-3.000

25 MM 1" TOP BOTTOM

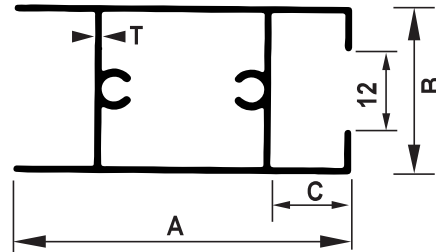

SEC. NO.	A	B	C	T	Wt. Range (Kg / 12ft)
PI-649	50.00	25.00	12.50	0.85	1.500-1.600
PI-650	50.00	25.00	12.50	1.00	1.800-1.900
PI-651	50.00	25.00	12.50	1.20	2.100-2.300
PI-652	50.00	25.00	12.50	1.50	2.700-3.000

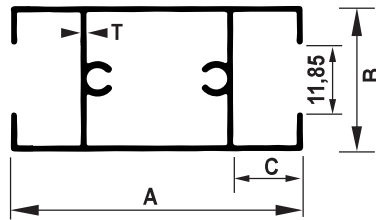

25 MM 1" MATTING

SEC. NO.	A	B	C	T	Wt. Range (Kg / 12ft)
PI-653	50.00	25.00	12.50	0.85	1.500-1.600
PI-654	50.00	25.00	12.50	1.00	1.800-1.900
PI-655	50.00	25.00	12.50	1.20	2.100-2.300
PI-656	50.00	25.00	12.50	1.50	2.700-3.000

CURTAIN WALL

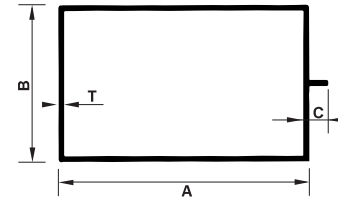

CURTAIN WALL

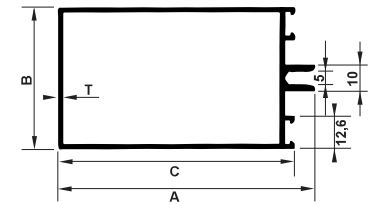

Sec. No.	A	B	T	Wt. Range (Kg / 12ft)
PI-393	50.00	50.00	1.70	4.000-4.200
PI-394	50.00	50.00	2.00	4.900-5.200
PI-395	63.00	50.00	1.70	6.000-6.300
PI-396	63.00	55.00	2.00	7.100-7.500
PI-397	100.00	50.00	1.70	6.400-6.800

Sec. No.	A	B	Wt. Range (Kg / 12ft)
PI-390	50.50	50.50	4.500-4.800

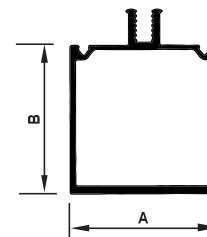

CURTAIN WALL

STRUCTURAL GLAZING

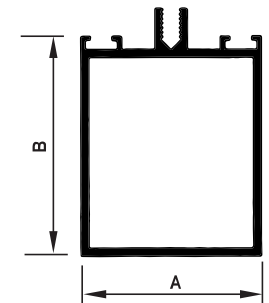

18MM SERIES

18MM 2 TRACK TOP

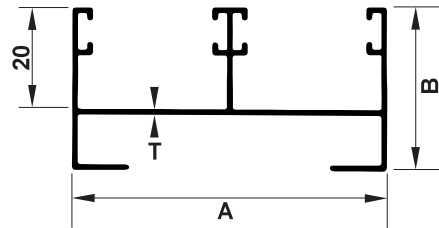

SEC. NO.	A	B	T	Wt. Range (Kg / 12ft)
PI-601	61.85	31.75	0.85	1.400-1.600
PI-602	61.85	31.75	1.00	1.800-2.000
PI-603	61.85	31.75	1.20	2.200-2.500

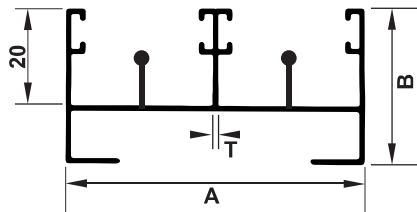

18 MM 2 TRACK BOTTOM

SEC. NO.	A	B	T	Wt. Range (Kg / 12ft)
PI-605	61.85	31.75	0.85	1.600-1.800
PI-606	61.85	31.75	1.00	1.900-2.200
PI-607	61.85	31.75	1.20	2.500-2.700

18 MM SINTEX A

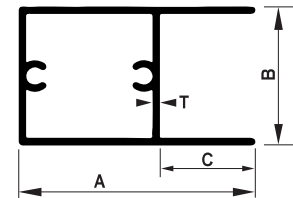

Sec. No.	A	B	C	T	Wt. Range (Kg / 12ft)
PI-596	40.00	23.60	16.30	0.75	0.950-1.100
PI-597	40.00	23.60	16.30	1.00	1.200-1.400

18 MM 18 X 80 MATTING

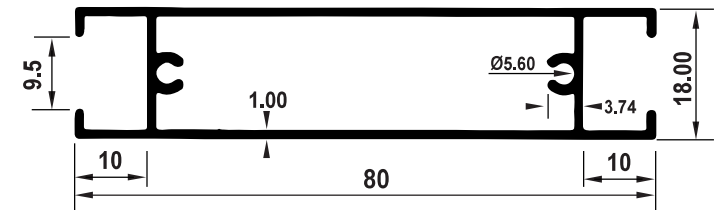

SECTION NO.: PI - 598

Weight: 2.208 kg / 12'

25 MM 1" HANDLE

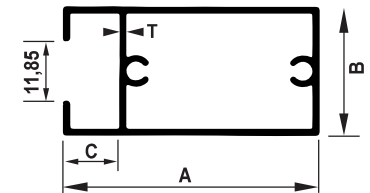

SEC. NO.	A	B	C	T	Wt. Range (Kg / 12ft)
PI-645	50.00	25.00	11.00	0.85	1.500-1.600
PI-646	50.00	25.00	11.00	1.00	1.800-1.900
PI-647	50.00	25.00	11.00	1.20	2.100-2.300
PI-648	50.00	25.00	11.00	1.50	2.700-3.000

18 MM 3/4" TOP BOTTOM

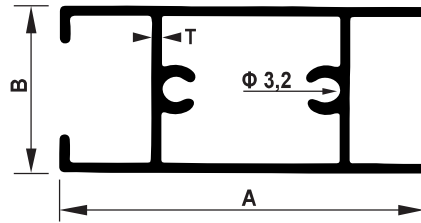

SEC. NO.	A	B	T	Wt. Range (Kg / 12ft)
PI-620	40.00	18.00	0.75	0.900-1.000
PI-621	40.00	18.00	1.00	1.200-1.400
PI-622	40.00	18.00	1.20	1.400-1.600

18MM 3 TRACK TOP

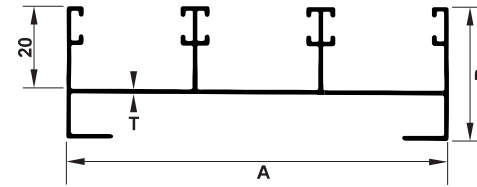

SEC. NO.	A	B	T	Wt. Range (Kg / 12ft)
PI-611	92.00	31.75	0.75	1.900-2.200
PI-612	92.00	31.75	1.05	2.500-2.800
PI-613	92.00	31.75	1.20	3.000-3.200

18 MM 3/4" INTERLOCK

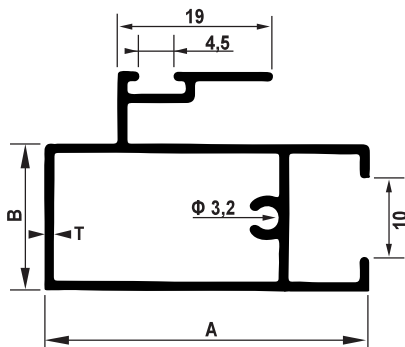

SEC. NO.	A	B	T	Wt. Range (Kg / 12ft)
PI-631	40.00	18.00	0.90	1.100-1.400
PI-632	40.00	18.00	1.10	1.350-1.550
PI-633	40.00	18.00	1.20	2.100-2.300

18MM 3 TRACK BOTTOM

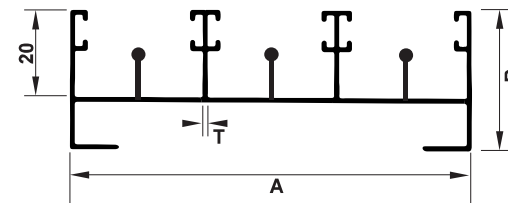

SEC. NO.	A	B	T	Wt. Range (Kg / 12ft)
PI-615	92.00	31.75	0.75	2.300-2.500
PI-616	92.00	31.75	1.00	2.600-2.800
PI-617	92.00	31.75	1.20	3.000-3.200

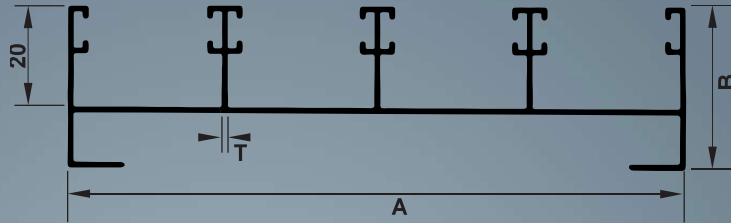

18 MM 4 TRACK TOP

SEC. NO.	A	B	T	Wt. Range (Kg / 12ft)
PI-635	122.00	31.75	1.00	3.300-3.500

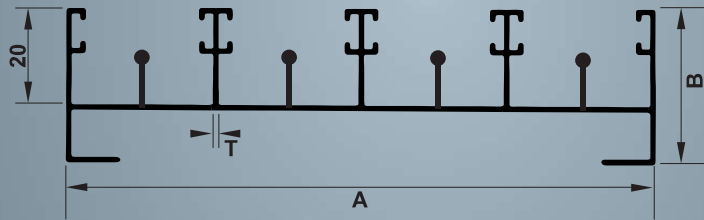

18 MM 4 TRACK BOTTOM

SEC. NO.	A	B	T	Wt. Range (Kg / 12ft)
PI-636	122.00	31.75	1.10	4.300-4.500

18 MM 3/4" HANDLE

SEC. NO.	A	B	T	Wt. Range (Kg / 12ft)
PI-625	40.00	18.00	0.75	0.900-1.000
PI-626	40.00	18.00	0.90	1.100-1.300
PI-627	40.00	18.00	1.20	1.400-1.600

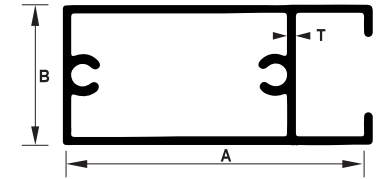

SEC. NO.	A	B	T	Wt. Range (Kg / 12ft)
PI-640	40.00	18.00	0.90	0.900-1.000
PI-641	40.00	18.00	1.00	1.200-1.400
PI-642	40.00	18.00	1.20	1.400-1.600

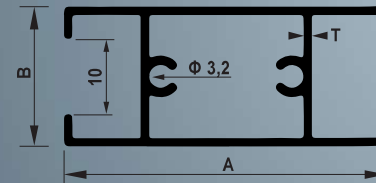

18 MM 3/4" MIDDLE

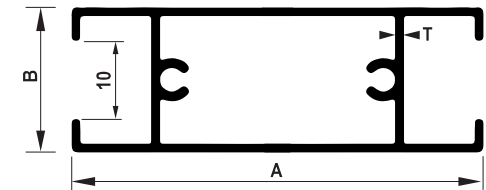

18 MM 3/4" MIDDLE

SEC. NO.	A	B	T	Wt. Range (Kg / 12ft)
PI-643	75.00	25.00	0.90	2.200-2.400